

devon IT

Alternative Desktop Computing



# TC5c

---

## Quick Start Guide

TC5Xc, TC5Dc

Mount the thin client in its vertical orientation for best performance. If it is necessary to mount the unit horizontally, make sure the unit is properly ventilated. Improper mounting can cause the unit to overheat and become damaged.

[www.devonit.com](http://www.devonit.com)

## Unpack

Your thin client terminal is typically shipped with the following items:

- Power Cord & Adapter
- Terminal Stand
- Quick Start Guide
- Warranty Card
- DVI Video Splitter Cable



Inspect all parts visually for damage. If anything is damaged, please contact Devon IT immediately to report the issue. You may use our web form (<http://www.devonit.com/support>) to create an inquiry ticket with the Devon IT Technical Support Department, or contact us by phone at 1-(800)-369-7290. Support Analysts are available 24/7/365.

## Getting Familiar with Your Thin Client

1. Power Button
2. Network Indicator LED
3. Audio line out
4. Microphone
5. RJ-45 Ethernet
6. USB 2.0 ports
7. DVI
8. PS/2
9. 12V DC Power Jack
10. Lock receptacle

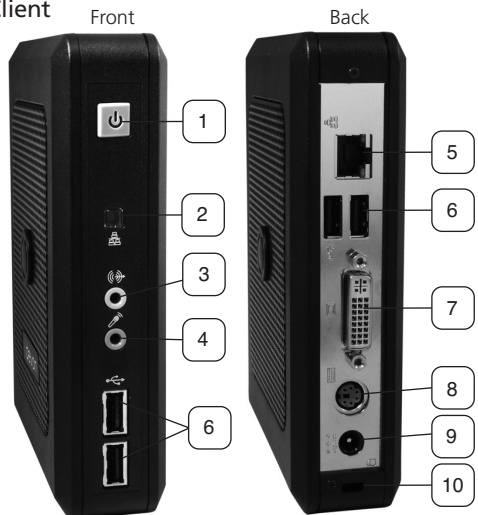

Please see the accompanying documents in the package for Warranty Information.

# Devon IT TC5c Terminal Quick Start Guide

*version1*

## Setup

1. Place the TC5c in the supplied terminal stand. The stand will keep the unit in a stable, vertical position.
2. Connect the monitor to the DVI Port on the back of the unit.
3. Connect the mouse and keyboard to the PS/2 or USB ports depending on what type you have.
4. Connect the network cable to the Ethernet Port on the unit and the other end of the cable to your local network.
5. Connect the power supply to the TC5c's power supply port on the back of the unit.
6. Plug the power cord into a surge-protected AC outlet.
7. Press the **Power** button to turn on the thin client.

## Warnings

- Make all necessary connections before powering unit on. Failure to do so may make the unit appear as if it is not functioning properly.
- Mount the thin client in its vertical orientation for best performance. If it is necessary to mount the unit horizontally, make sure the unit is properly ventilated. Improper mounting can cause the unit to overheat and become damaged.
- Do not shut the thin client down by removing the power cord. Loss of power can damage the unit.
- It is important to not interrupt the power to the thin client while executing a firmware upgrade. Loss of power can result in a damaged operating system.
- Do not place anything on or over the terminal.
- Excessive sound pressure from earphones and headphones can cause hearing loss. Adjustment of the equalizer to maximum increases the earphones and headphones output voltage and therefore the sound pressure level.
- Power adapter: Au-7991n
- Lithium battery Caution: Danger of explosion if battery is incorrectly replaced. Replace only with the same or equivalent type recommended by the manufacturer. Dispose of used batteries according to the manufacturer's instructions. Do not remove cover, no user serviceable components inside. Take unit to service center for repairs and servicing.

# Windows Embedded Standard (WES) Instructions for TC5c Terminals Running WES

## System Start

Two local user accounts exist on the system:

- **Administrator** – The default password is Administrator (case sensitive)
- **User** – By default, there is no password required for this account.

The thin client automatically logs in as the "User" account. In order to log in as the "Administrator", you must first gain access to the Windows XP Logon screen.

There are two ways to do this:

<i>During User Logoff</i>	<b>-OR-</b>	<i>During System Bootup</i>
<p>While logged in as "User," select "Start Menu -&gt; Log Off."</p> <p>You will receive a small window prompt asking you to confirm. Hold the <b>Shift</b> key as you press the <b>Log Off</b> button.</p> <p>You will now be presented with the Windows XP Logon screen.</p>	<p> </p>	<p>As the unit is booting the Windows OS, hold down the <b>Shift</b> key. This will bypass the automatic login and present you with the Windows XP Logon screen.</p> <p>You may now choose to login with the Administrator or User account</p>

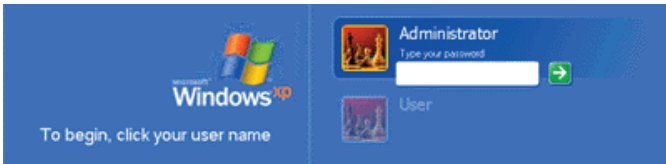

Hold the **Shift** key during bootup or logoff to access the Logon Screen

## WES - Instructions for TC5c Terminals Running WES (continued)

### Dual Monitors

You can attach two monitors to the TC5c by using the supplied DVI Video Splitter Cable.

- With the unit turned off, attach the splitter to the DVI port of the terminal. Connect the monitors to the other ends of the cable and then power on the terminal.
- Use the Intel Graphics Media Accelerator utility to choose extended desktop. This can be found by right-clicking the mouse anywhere on the Windows Desktop and then selecting "Graphics Properties ..."
- Make sure that the two displays selected are "Digital Display" and "Monitor". Ignore the third option called, "Notebook", if it should appear.
- On the left-hand side of the window, select "Display Settings" to change the resolution, color depth, rotation, and power settings for the attached monitors.

### FBWF Manager

The FBWF (File Based Write Filter) operates by providing a "shadow write" to the system RAM. When enabled, any writes that are normally written to the storage media, are instead redirected to the RAM overlay. During a reboot, this overlay is discarded, so the operating system remains in its original state.

As the name implies, FBWF is based on files. This means you can exclude certain files and directories from the protection of the write filter. Any files that are in this list are ignored by FBWF and subject to modification (or deletion) just as they normally would in any standard Windows XP environment.

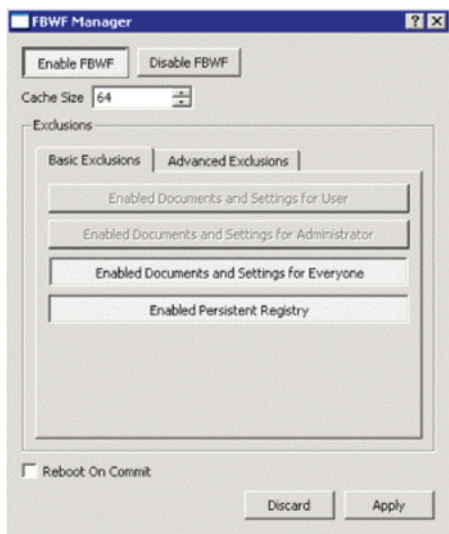

## **WES** - *Instructions for TC5c Terminals Running WES (continued)*

### **FBWF Manager** *(continued)*

The TC5c includes a management utility for configuring FBWF. Only Administrators can access this utility.

#### **To open the FBWF Manager:**

- Log in as Administrator.
- Choose "Start Menu -> All Programs -> FBWFGUI"
- This will open the FBWF Manager window.

By default, FBWF is in an enabled state, with basic exclusions set for the "Persistent Registry" and "Documents and Settings" for all users. This means any changes made under the "C:\Documents and Settings" folder, such as desktop icons, start menu items, and browser favorites, will be written directly to the flash device immediately and without overlay protection.

### **Installing Additional Software**

You may install third party licensed software as long as there is adequate space on the flash media. This section describes the recommended procedure for using FBWF to permanently install additional software applications:

- Login as Administrator and select "Start Menu -> All Programs -> FBWFGUI"
- Temporarily disable the write filter by clicking the **Disable FBWF** button, then press the **Apply** button.
- Reboot the terminal.
- Login again as Administrator and install the new software.
- After installation, verify the application is working as expected.
- Launch the FBWF Manager and click the **Enable FBWF** button. Also, make sure to re-enable the Basic Exclusions. For default exclusions, this would mean selecting the buttons for **Enabled Documents and Settings for Everyone** and the **Enabled Persistent Registry** buttons.
- Click the **Apply** button and Reboot the terminal one last time.

# Devon IT TC5c Terminal Quick Start Guide

*version1*

**WES** - *Instructions for TC5c Terminals Running WES (continued)*

## **Where to Go From Here**

Please visit the support page on our website, <http://www.devonit.com/support>, to download the latest documentation for the Windows Embedded Standard operating system.

You will also find web forms that allow you to create inquiry tickets with the technical support department and submit Return Material Authorization (RMA) forms for our products.

Support Center phone lines are open 24 hours, 7 days a week.

**Toll Free:** 1-800-369-7290

**Local Phone:** 610-757-4220

Warranty information and registration can be found at:

<http://www.devonit.com/products/products-warranty.php>

## DeTOS

### Instructions for TC5c Terminals Running DeTOS

#### System Start

1. Press the Power Button to turn on the terminal.
2. Once the boot process is finished, your thin client will display the DeTOS desktop and taskbar.
3. The network configuration is set to DHCP by default. To check the network connection status, click the DeTOS button that is located on the bottom right-hand corner of the screen, and then select DeTOS Control Panel.
4. Along the bottom of the DeTOS Control Panel is a row of status messages. These messages include the OS Build for DeTOS, the terminal's current IP address, and a Thin Client Management Connection Indicator.



#### DeTOS Control Panel

- **Connections:** Your terminal has the ability to connect to remote servers utilizing several types of protocols. The rDesktop client uses the RDP protocol and allows you to connect to Microsoft Windows Terminal Servers. The Citrix ICA client is used to establish connections to Citrix Presentation and XenApp servers. The VMware View client allows you to connect to a VMware View server, which in turn, provides the end-user with their own virtual desktop session. Lastly, you may create a Firefox Web Browser connection to surf the web. This can be used for several purposes:
  - Connect to a web applications; e.g., a webmail server.
  - Connect to a connection broker web interface; e.g., Citrix XenDesktop.
  - Use the thin client as a Kiosk (select the "Enable Kiosk Mode" button under the "Kiosk Mode" panel)

## DeTOS - Instructions for TC5c Terminals Running DeTOS (continued)

### DeTOS Control Panel (continued)

- **System Settings:** These are the display, sound, keyboard, mouse, printer and date/time configurations for your terminal. Also under the System section, is the ability to set an administrative password for the control panel and change the local storage mode.

### Dual Monitors

You can attach two monitors to the TC5c by using the supplied DVI Video Splitter Cable.

1. With the unit turned off, attach the splitter to the DVI port of the terminal. Connect the monitors to the other ends of the cable, and then power on the terminal.
2. The display will be mirrored on both monitors.
3. From the DeTOS Desktop, select **DeTOS** → **DeTOS Control Panel**
4. Click the **Display** icon on the left hand side of the Setup window.
5. You will be presented with display settings for **Color Depth** and **Screen Blanking** options. These settings apply to both monitors.
6. To adjust *specific* properties for each monitor, click the **Monitors** button along the top of the Control Panel. You will then be presented with the names of the two monitors attached to the terminal. The exact names will vary, depending on how they are detected on that particular terminal.

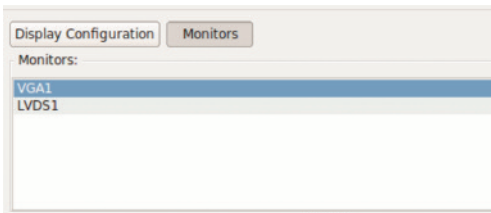

7. Click one of the monitor names from the list. This will open a configuration screen that contains **Resolution, Position, Rotation, and Reflection** properties for that specific monitor.
8. Once you are finished, press the **Apply** button and **Reboot** the terminal for the changes to take effect.

## DeTOS - Instructions for TC5c Terminals Running DeTOS (continued)

### System Password

A System Password can be set to restrict access to the DeTOS Control Panel.

#### System Password

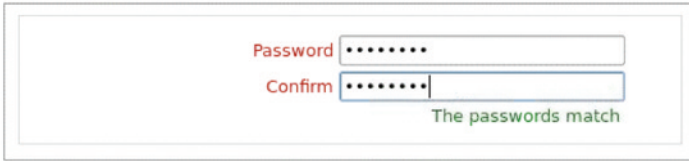

Password [masked]

Confirm [masked]

The passwords match

#### To set the Password:

1. Select DeTOS → DeTOS Control Panel
2. Click the Management icon on the left hand side of the Setup window.
3. Click the [ + ] to open the Agent Password section of this screen.
4. Enter a password in the Password field.
5. Re-enter the same password in the Confirm field.
6. Press the Apply button.

#### NOTE:

Once a system password is set, the user will be prompted for the password when they attempt to open the DeTOS Control Panel. If the Cancel button is pressed, then the Control Panel will open in a read-only mode. A small padlock icon will also appear along the bottom of the Control Panel window, indicating that edits are disallowed.

### Where to Go From Here

Please visit the support page on our website, <http://www.devonit.com/support>, to download the latest Administration Manual for the DeTOS operating system. You will also find web forms that allow you to create inquiry tickets with the technical support department and submit Return Material Authorization (RMA) forms for our products.

Support Center phone lines are open 24 hours, 7 days a week.

**Toll Free:** 1-800-369-7290

**Local Phone:** 610-757-4220

**DeTOS** - *Instructions for TC5c Terminals Running DeTOS (continued)*

**Where to Go From Here** *(continued)*

Warranty information and registration can be found at:

<http://www.devonit.com/products/products-warranty.php>

# TC5c

---

Quick Start Guide



**Devon IT, Inc.**  
1100 First Ave.  
King of Prussia, PA 19406

[devonit.com](http://devonit.com)